

All European
 Luke Wright
 308 E. Parent
 48067 MI Royal Oak
 Phone no. +18002553876
 E-mail lwright@alleuro.com

Customer data

.....
Name

.....
Street

.....
Postcode *Town/City*

.....
Country

.....
Licence plate number *Kilometer/mileage reading*

.....
VIN

 **Timing belt data**

BMW 7 Ser.

Year of constr. 2006-2008 • 4799 ccm • 270 kW

<https://www.hgs-data.com/index.php/timingbelt/index/vehicleId/4598>

Contents

1	Version: Timing chain	2
1.1	Tools	2
1.2	Dismounting 1	2
1.3	Dismounting 2	3
1.4	Dismounting 3	4
1.5	Mounting 1	5

1 Version: Timing chain

1.1 Tools

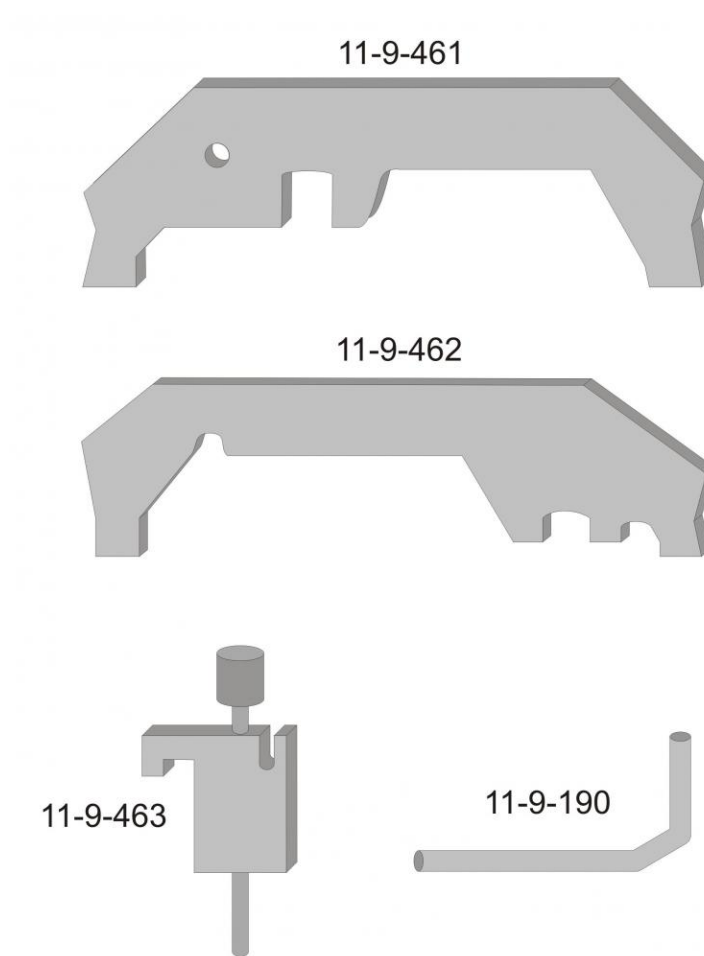

- 11-9-461 = Intake camshaft locking tool
- 11-9-462 = Exhaust camshaft locking tool
- 11-9-463 = Camshaft tool holder.
- 11-9-190 = Locking tool for crankshaft pulley / vibration damper

1.2 Dismounting 1

- Dismount power steering pump and move it aside.
- Dismount valve cover.
- Remove ignition coils.
- Remove spark plugs.
- Remove oil pipe in cylinder head.
- Remove cooling fan.

1.3 Dismounting 2

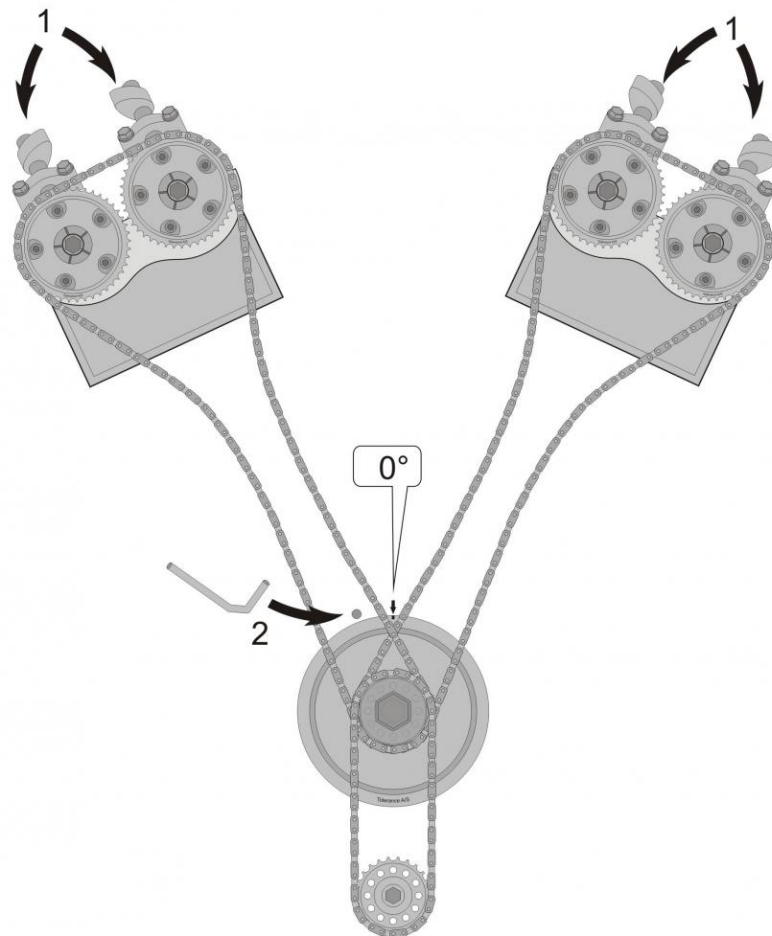

- Turn the engine clockwise to the marks.
- Check that intake and exhaust cams on cylinder 1 point upwards and inwards.
- Check that intake and exhaust cams on cylinder 5 point downwards and inwards.
- Lock crankshaft pulley / vibration damper using tool "11-9-190".

1.4 Dismounting 3

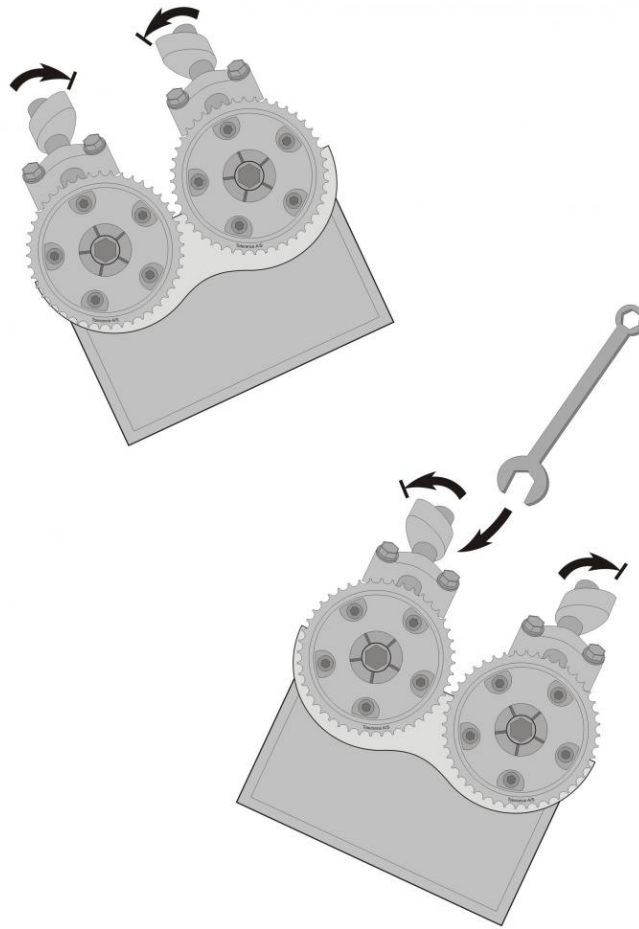

- Check that the variable camshaft timing is adjusted:
- Turn both intake camshafts against the normal direction of rotation until great resistance can be felt.
- Turn both exhaust camshafts in the normal direction of rotation until great resistance can be felt.
- Remove the chain together with the camshaft gear.

1.5 Mounting 1

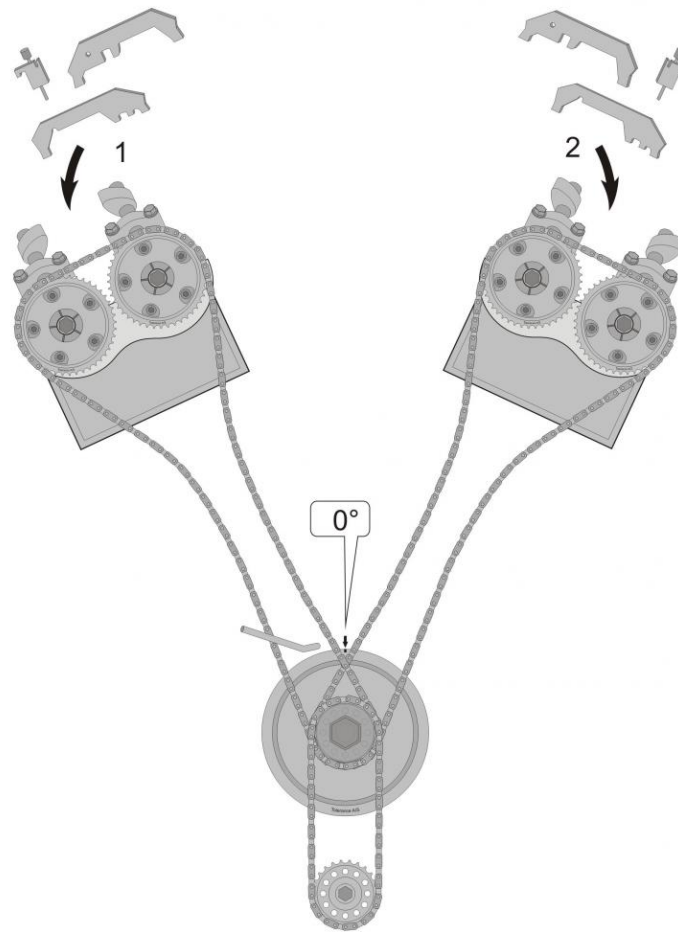

- Fix the camshaft gears loosely so they can turn freely on the shafts.
- Mount the chain.
- Lock intake camshafts using tool "11-9-461".
- Lock exhaust camshafts using tool "11-9-462".
- Tighten camshaft pulley bolt (use counter hold).
- Turn crankshaft 720°.
- Turn the engine clockwise to the marks.
- Control of camshaft timing.
- Install the remaining parts in opposite sequence.